

Mississippi State University

## Scholars Junction

---

Mississippi State House, Jackson, Miss.  
1901-1903

Mississippi Photographs and Postcards

---

1903

### Floor Plan for the Second Story, New State Capitol Building (Mississippi State House), Jackson, Mississippi

Follow this and additional works at: <https://scholarsjunction.msstate.edu/mss-lampton-images-ms-state-house>

---

#### Recommended Citation

Lucius Marion Lampton, MD Historical Images Collection, Special Collections Department, Mississippi State University

This Photograph is brought to you for free and open access by the Mississippi Photographs and Postcards at Scholars Junction. It has been accepted for inclusion in Mississippi State House, Jackson, Miss. 1901-1903 by an authorized administrator of Scholars Junction. For more information, please contact [scholcomm@msstate.libanswers.com](mailto:scholcomm@msstate.libanswers.com).



MISSISSIPPI STATE HOUSE

THEO. C. LINK ARCHITECT ST. LOUIS

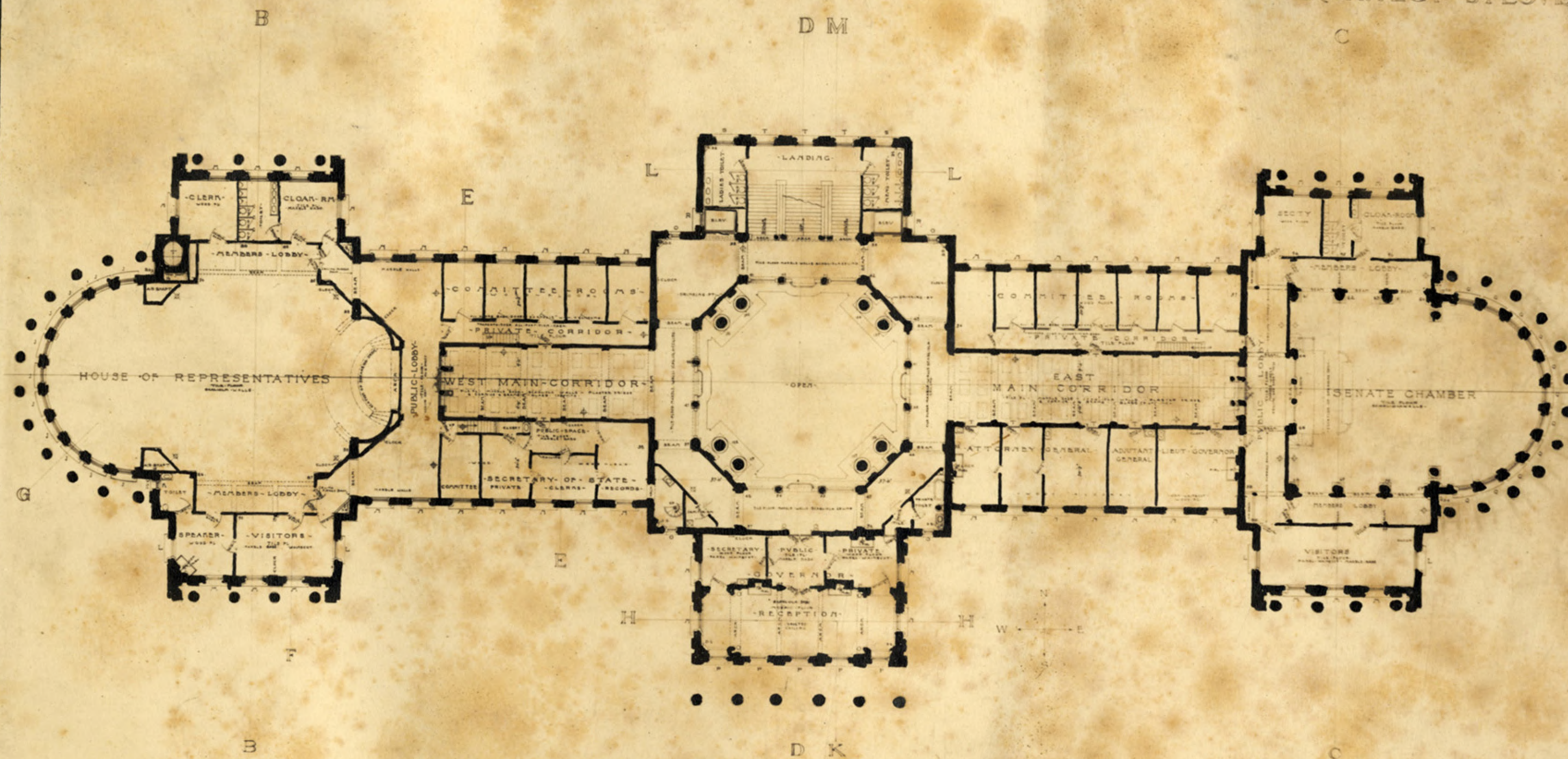

SECOND FLOOR PLAN

SCALE 1/8" = 1' FOOT  
SHEET NO 5

THESE PLANS ARE HEREBY SUBMITTED TO THE LEGISLATURE  
AND TO THE PEOPLE OF THE STATE OF MISSISSIPPI  
FOR THEIR CONSIDERATION AND APPROVAL  
THEO. C. LINK ARCHITECT  
ST. LOUIS, MO.  
JANUARY 1901